



Manufacturers and Distributors of  
Pharmaceutical specialities &  
Surgical disposable patient care devices



**ATUL DRUG HOUSE**



**Vision:**

To emerge as one of India's most valued companies providing global technology and knowledge to help enrich the lives of our customers.

**Mission:**

To research, develop, implement and operate our businesses through knowledge led technologies strengthened with alliances as required.

**Goals:**

To create value for our customers through proactive corporate governance and value added services.

To develop a team of business associates fully supported by our own competitive knowledge capital.

Atul Drug House was established in erstwhile Bombay (now Mumbai), India in 1953. From a controlled compact manufacturing environment with a solid thrust on research and development the company introduced products tailor made to the needs of customers. As opportunities arose the company began concentrating on specific expertise to bring to the fore world renowned and proven technology to India.

This resulted in getting technical knowhow from world leaders:

LABORATORIES VIFOR, GENEVA  
LABORATORIES HOUDE, PARIS  
RITCHER LABORATORIES, ITALY

The company soon embarked on path breaking innovations in the medical field and were the first Indian company to manufacture and market Pharmaceutical Specialities and Surgical Disposable Patient Care Devices all over the country. This was against all prevailing norms as disposable patient care devices were considered a "luxury". Today, we at ADH, are proud to be the pioneers in these devices and for having the foresight to bring disposable medical products to India which are now the order of the day.

As we go forward, in this fast paced technology driven world where communications is a matter of pressing a button and situations change it is time to move on. To meet the bigger and brighter challenges that are opening up before us we now offer under our umbrella a wider scope of products focused to catering anywhere on the globe.

Welcome to the new Atul Drug House.



Urocom



- Urine collection bag of 2000 ml capacity.
- Efficient non – return valve as a barrier against ascending urinary tract infection and urine outlet at top of bag for bed side use.
- Full pressure compensation provided to ensure free entry of urine into the bag.
- Kink resistant tube of 1 M length of larger bore, clinical grade P.V.C.
- Nozzle fits all sizes of urinary catheters.
- Every unit is checked for leakage at manufacturing stage.
- Sterile and disposable, for single patient use.

Pack of 25/Master Box of 100

Ecosac



- Urine collection bag of 2000 ml capacity.
- Efficient non – return valve as a barrier against ascending urinary tract infection and urine outlet at top of bag for bed side use.
- Full pressure compensation provided to ensure free entry of urine into the bag.
- Kink resistant tube of 1 M length, clinical grade P.V.C.
- Every unit is checked for leakage at manufacturing stage.
- Sterile and disposable, for single patient use.

Pack of 25/Master Box of 100



Urocom Leg Bag



- Urine collection bag of 600 ml capacity.
- Efficient non – return valve as a barrier against ascending urinary tract infection.
- Elastic straps for fitting the bag on the leg for ambulatory patients.
- Manufactured from Clinical grade P.V.C. kink resistant tubing.
- Urine outlet is at the bottom of the bag.
- Every unit is checked for leakage at manufacturing stage.
- Sterile and disposable, for single patient use.

Pack of 25/Master Box of 100

Urocom CVC



- Calibrated Volume Container (burette) of 200 ml is directly attached to urine collection bag of 2000 ml capacity for monitoring and measuring urine output hourly.
- Efficient non – return valve as a barrier against ascending urinary tract infection and urine outlet at top of bag for bed side use.
- Full pressure compensation provided to ensure free entry of urine into the bag.
- Kink resistant tube of 1 M length, clinical grade P.V.C.
- Nozzle fits all sizes of urinary catheters.
- Every unit is checked for leakage at manufacturing stage.
- Sterile and disposable, for single patient use.

Available in 1.0mt, 1.5mt & 2.0 mt

Box of 1/Master Box of 40

Minicom



- Pediatric urine collection bag of 100 ml capacity for male/female infants & new borns.
- Manufactured with tear – resistant plastic material with calibrated volume markings up to 100 ml.
- A hypo – allergenic medical grade adhesive for fixing on sensitive skin of infants.
- It is cushioned with foam at the edges of the opening to prevent discomfort and irritation.
- Can be used for collecting adult urine samples and self sealed for analysis.
- Sterile and disposable, for single patient use.

Box of 100/Master Box of 2000

Unicath

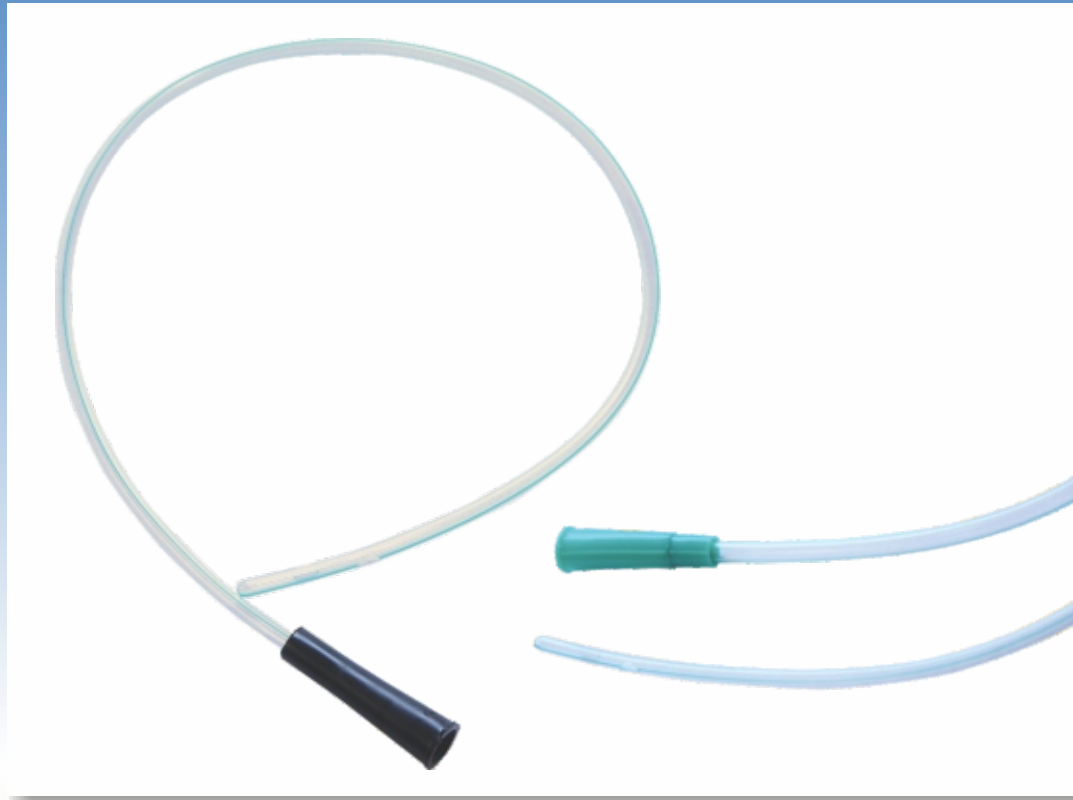

- For short term bladder catheterization through urethra.
- Soft, frosted, non-toxic and kink-resistant medical grade PVC tube.
- Atraumatic, soft and rounded closed tip with two lateral eyes for effective drainage.
- For proper X-ray visualization, Radio-opaque line provided throughout the length of the catheter.
- Universal funnel shape connector for easy connection to urine bag.
- Colour coded connectors for easy identification of size.
- Sterile, pyrogen free and disposable.
- Individually packed in paper pouch.

Size	FG 6	FG 8	FG 10	FG 12	FG 14	FG 16	FG 18	FG 20
Colour	Green	Light Blue / Sky Blue	Black	White	Green	Orange	Red	Yellow

Length – 40 cm. Pack of 25/Master Box of 3000

Infusion Set With Airvent – A



- Safe and effective TERMINAL FLUID FILTER to prevent the invisible suspended particular matter in I.V. fluids from entering the patient's vein.
- Sturdy, air vented plastic trocar (spike) minimises resistance while penetrating rubber and plastic closures of I.V. fluid containers.
- Flexible drip chamber specially blended with nontoxic plastic material with flexibility and transparency, for easy priming and visibility.
- Kink resistant tube of 150 cm with a smooth roller clamp which facilitates accurate flow and adjustment of fluids.
- Latex Bulb injection port for extra medication. 21 G needle with luer lock.
- Approximately 20 drops/ml.
- Sterile, pyrogen free and disposable.

Pack of 25/Master Box of 200

Infusion Set Without Airvent – E



- Safe and effective TERMINAL FLUID FILTER to prevent the invisible suspended particular matter in I.V. fluids from entering the patient's vein.
- Sturdy, non – vented plastic trocar (spike) minimises resistance while penetrating rubber and plastic closures of I.V. fluid containers.
- Flexible drip chamber specially blended with nontoxic plastic material with flexibility and transparency, for easy priming and visibility.
- Kink resistant tube of 150 cm with a smooth roller clamp which facilitates accurate flow and adjustment of fluids.
- Latex Bulb injection port for extra medication. 21 G needle with luer lock.
- Approximately 20 drops/ml.
- Sterile, pyrogen free and disposable.

Pack of 25/Master Box of 200

Blood Giving Set With Airvent – F



- Flexible and cylindrical double drip chamber provided with 200 micron filter to prevent passage of any clot in to the chamber.
- Sharp, sturdy, vented plastic trocar (spike) minimises resistance while penetrating blood bottles, blood bags and all standard types of blood containers.
- Latex Bulb injection port for extra medication. 19 G needle.
- Kink resistant tube of 150 cm with a smooth roller clamp which facilitates accurate flow and adjustment of infusion rate.
- Sterile, pyrogen free and disposable.

Pack of 25/Master Box of 200

Blood Giving Set Without Airvent – H



- Flexible and cylindrical double drip chamber provided with 200 micron filter to prevent passage of any clot in to the chamber.
- Sharp, sturdy, non – vented plastic trocar (spike) minimises resistance while penetrating blood bottles, blood bags and all standard types of blood containers.
- Latex Bulb injection port for extra medication. 19 G needle.
- Kink resistant tube of 150 cm with a smooth roller clamp which facilitates accurate flow and adjustment of infusion rate.
- Sterile, pyrogen free and disposable.

Pack of 25/Master Box of 200

Micro-Drip



- Pediatric / Precision I.V.set without airvent with TERMINAL FLUID FILTER to prevent the invisible suspended particular matter in I.V. fluids from entering the patient's vein.
- Sturdy, non – vented plastic trocar (spike) minimises resistance while penetrating rubber and plastic closures of I.V. fluid containers.
- Flexible drip chamber with micro-dropper specially blended with nontoxic plastic material with flexibility and transparency, for easy priming and visibility.
- Kink resistant tube of 150 cm with a smooth roller clamp which facilitates accurate flow and adjustment of fluids.
- Latex Bulb injection port for extra medication. 21 G needle with luer lock.
- Approximately 60 drops/ml.
- Sterile, pyrogen free and disposable.

Pack of 25/Master Box of 200

Comset M – CVC

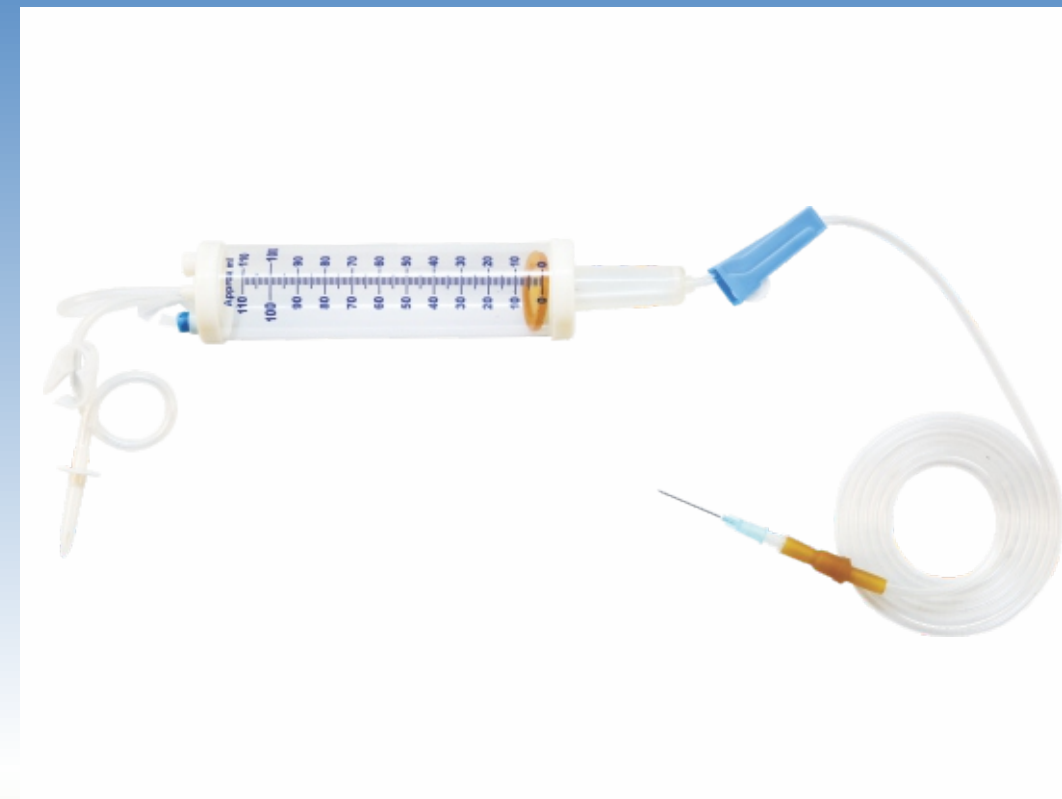

- Pediatric / Precision I.V.set without airvent with a Calibrated Volume Container (burette) of 110 ml specially blended with nontoxic plastic material with flexibility and transparency, for easy priming and visibility.
- Moulded drip chamber and micro-dropper giving approximately 60 droplets per ml.
- Floating automatic shut off valve prevents air to be trapped in the fluid line and helps for monitoring and measuring the level of liquid.
- Kink resistant tube of 150 cm with a smooth roller clamp which facilitates accurate flow and adjustment of fluids.
- Latex Bulb injection port for extra medication. 21 G needle with luer lock.
- Hanging facility of complete device on the I.V. stand.
- Sterile, pyrogen free and disposable.

Box of 1/Master Box of 50



## Scalp Vein Set



- Short - Bevelled Siliconised and thin walled needle for atraumatic cannulation and better flow rate per gauge.
- Butterfly wings needle mount facilitates easy handling and attachment to the skin.
- Butterfly wings are colour coded for easy identification of needle size.
- I.V. fluid administration set for use in tandem with other infusion sets.
- The end of the set has a female adapter to fit the male adapter of other infusion sets.
- Soft non-toxic, kink resistant tube.
- Sterile, pyrogen free and disposable.
- Individually packed in Blister pack.

Size	FG 18	FG 19	FG 20	FG 21	FG 22	FG 23	FG 24
Colour	Red	Brown	Yellow	Green	Black	Light Blue / Sky Blue	Red

Length – 30 cm. Pack of 100/Master Box of 3000

## Accuflo

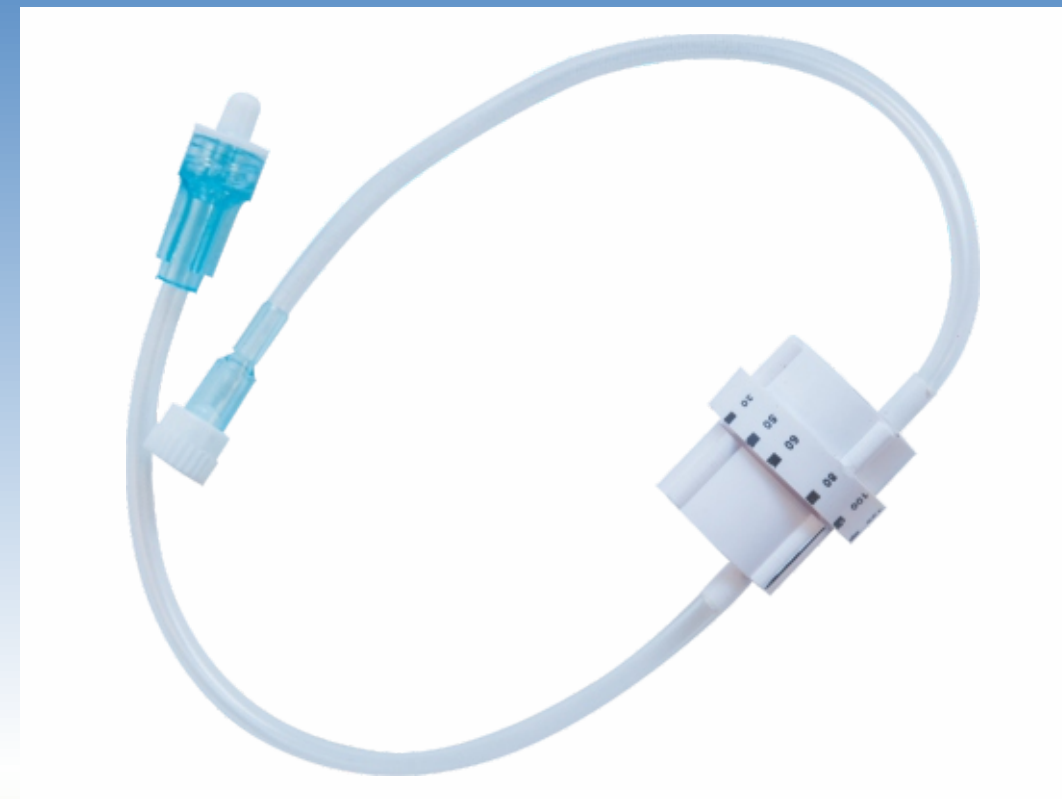

- Accuflo ensures precise flow control.
- Ensures exact doses over prolonged infusions, for higher degrees of safety.
- Precise flow rate control of IV fluids with range of 5ml/hr to 250 ml/hr.
- Soft and kink resistant PVC tubing.
- Male luer connector at one end and female luer connector at other end.
- Also available with "Y" type injection port for extra medication.
- Can be used with all standard I.V sets.
- I.D. : 2.8 mm and O.D. : 3.8 mm
- Sterile, pyrogen free and disposable.
- Individually packed in Blister pack.

Master Box of 300

Rotaflo



- Transparent, non-toxic one – piece body moulded from Lexan (regd. T.M. of GE Plastics, U.S.A.)
- Luer Lock, rotating nut on male port for secure leak proof connection.
- Luer Lock female ports fit tightly on all ports and connectors.
- Compact size and low profile for stable positioning on patients.
- Leakproof device withstands pressure up to 3 bars (43.51 psi) applied in all forced infusions by pumping systems.
- Transparent base and ports permit observation of flow and removal of air bubbles.
- Flow direction indicating arrows on all three arms of the tap.
- Minimal dead space for accurate dosing of medication.
- Smooth and uniform lumen prevents turbulence and bubble formation.
- Sterile, pyrogen free and disposable.
- Individually packed in Blister pack.

Box of 50/Master Box of 500

Rotaflo-Ext



- Extension line with three way stop cock at one end & male luer lock connector at other end.
- Soft, frosted & kink resistant PVC tubing provides uninterrupted fluid movement.
- Extension Tube: I.D.: 2.8 mm and O.D.: 3.8 mm.
- Can be used with all standard equipment.
- Can sustain a pressure up to 3 bars (43.51 psi).
- Tube length: 10, 25, 50, 100, 150 & 200 cm.
- Sterile, pyrogen free and disposable.
- Individually packed in Blister pack.

Length	Prime Volume
10 cm	00.76 ml
25 cm	01.90 ml
50 cm	03.80 ml
100 cm	07.60 ml
150 cm	11.40 ml
200 cm	15.20 ml

Box of 50/Master Box of 300

## Pressur-Ext



- Small bore high pressure extension line suitable for high pressure monitoring
- Kink resistant PVC tubing made of clear, non-toxic medical grade PVC material.
- Suitable for high pressure monitoring and for connection between syringe infusion pump and patient.
- Male luer lock at one end & female luer lock at other end.
- Extension Tube: I.D.: 1.80 mm and O.D.: 2.80 mm
- Can be used with all standard equipment.
- Can sustain a pressure up to 500 ps or 34 bar.
- Tube length: 10, 50, 100, 150 & 200 cm.
- Also available with Male luer lock at one end & Male luer lock at other end.
- Sterile, pyrogen free and disposable.
- Individually packed in Blister pack.

Length	Prime Volume
10 cm	00.49 ml
50 cm	02.45 ml
100 cm	04.90 ml
150 cm	07.35 ml
200 cm	09.80 ml

Box of 50/Master Box of 300

## Luer-Ext



- Soft, non-toxic and kink-resistant medical grade PVC tube.
- Male luer lock at one end & female luer lock at other end
- Extension Tube: I.D.: 2.8 mm and O.D.: 3.8 mm.
- Tube length: 60, 90, 180 cm.
- Sterile, pyrogen free and disposable.

Master Box of 300

CVP Manometer



- Designed to measure and monitor continuous or intermittent, central venous pressure.
- Manometer tube with graduations marked from –4 cm to +34 cm and attached to three way stopcock.
- 120 cm long extension tube is fitted with female luer lock on one end and male luer lock on the other end for safe connection to Central Venous Catheter.
- Sliding indicator provided to record previous reading.
- Moulded clamps with latex rubber strings are provided for fixation to I.V. stand.
- Y Injection site / Latex rubber flash bulb is provided for extra medication.
- Sterile, pyrogen free and disposable.
- Individually packed in paper pouch.

Box of 1/Master Box of 50

Suction Catheter

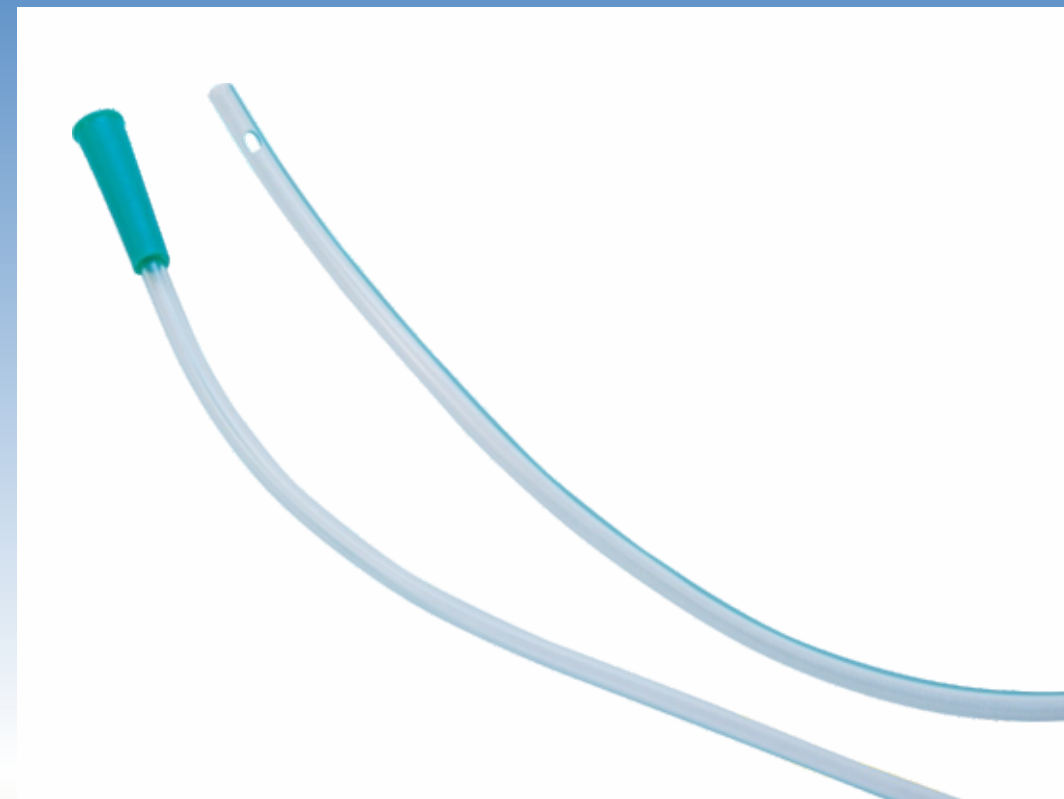

- For removal of secretion from mouth, trachea and bronchial tubes.
- Soft, frosted, non-toxic, kink-resistant medical grade PVC tube is used for easy insertion and patient comfort.
- Atraumatic, soft and rounded distal end is open with one lateral eye.
- Colour coded connectors for easy identification of size.
- Sterile, pyrogen free and disposable.
- Individually packed in paper pouch.

Size	FG 6	FG 8	FG 10	FG 12	FG 14	FG 16	FG 18	FG 20
Colour	Green	Light Blue / Sky Blue	Black	White	Green	Orange	Red	Yellow

Length – 50 cm. Pack of 25/Master Box of 2000



## Oxinovel

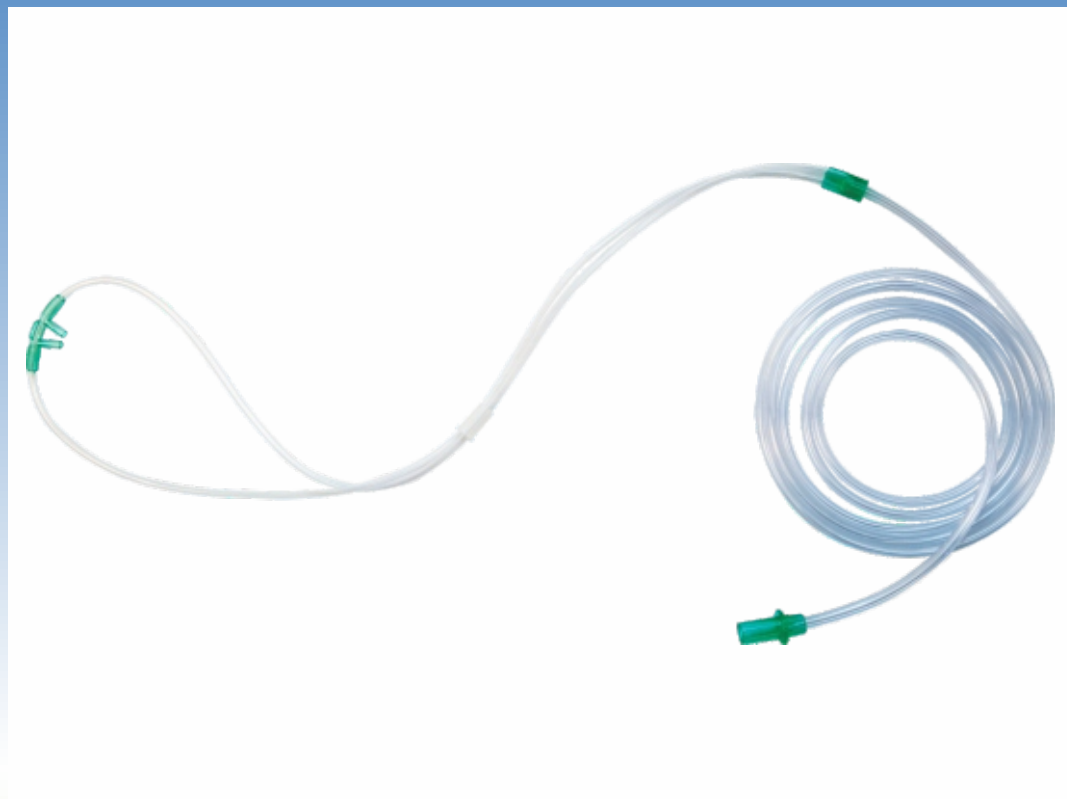

- Especially designed for easy application and efficient administration of oxygen.
- Made from soft to extra-soft PVC, non-toxic material.
- The softness and special design of the cannula avoids irritation and discomfort even during long – term treatments.
- Enables eating, speaking and sleeping in comfort and freedom for patient.
- Nasal Twin probe has perforated tips to reduce the velocity of Oxygen which prevents drying of nostrils and Oxygen “burns”.
- Soft funnel shaped connector helps to provide maximum comfort.
- Female Nozzle is of universal size to fit any humidifier.
- Sterile, pyrogen free and disposable, individually packed in poly bag.

Tube Length: - 200 cm. Size: - Adult, Child. Pack of 1/Master Box of 250.

## Oxygen Mask



- Especially designed for convenient oxygen therapy during surgery or critical care to the patients.
- Made from non-toxic and non-irritant medical grade PVC material.
- Provided with adjustable elastic strap for proper positioning of mask.
- Kink - resistant tube to ensure continuous flow of oxygen.
- Proximal end fitted with soft funnel shape connector for easy connection to oxygen source.

Tube Length: 200 cm. Size: Adult, Child. Pack of 1/Master Box of 250.

## Ryle's Tube

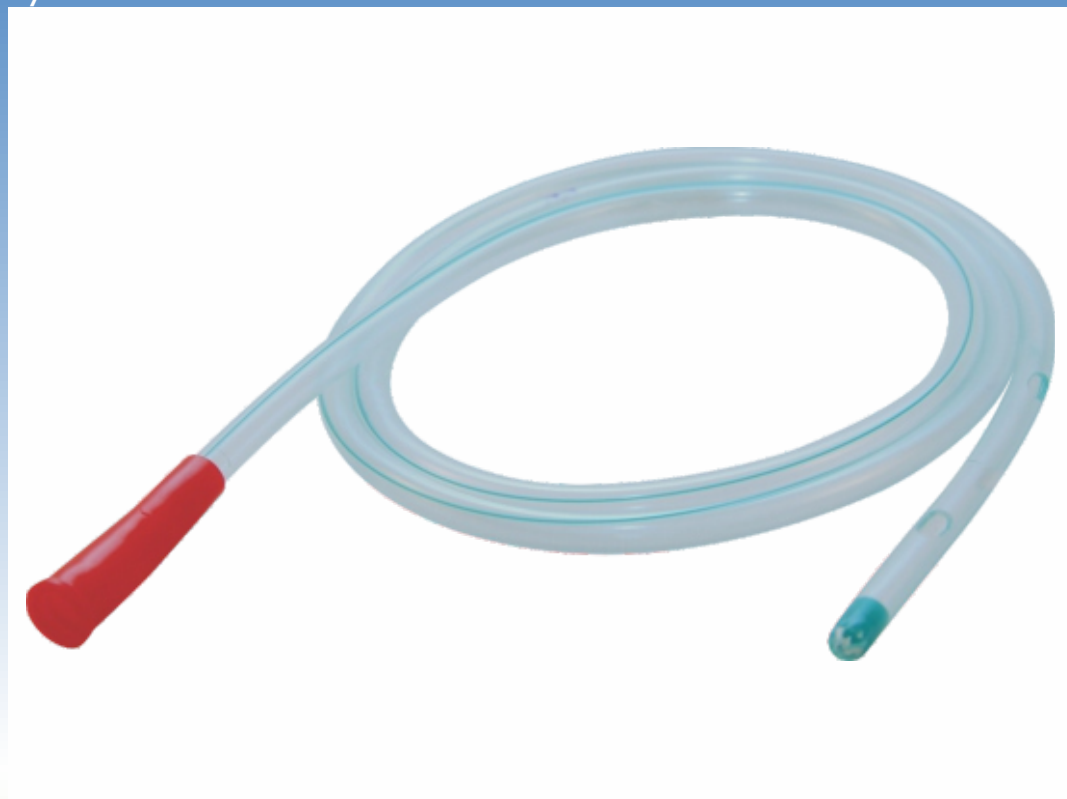

- Nasogastric tube with weighted S.S.balls for gastro/duodenal feeding or aspiration.
- Tube with lateral perforations at distal end.
- Tube having radio – opaque line, marked at 50cm, 60cm & 70 cm from the tip for accurate placement.
- Colour coded for easy and instant size identification.
- Sterile and disposable, for single patient use.

Size	FG 6	FG 8	FG 10	FG 12	FG 14	FG 16	FG 18	FG 20
Colour	Green	Light Blue / Sky Blue	Black	White	Green	Orange	Red	Yellow

Length – 105 cm. Pack of 25/Master Box of 2000

## Infant Feeding Tubing



- For neonatal and paediatric nutritional feeding.
- Non-toxic PVC tube completely non-irritant to delicate mucosa and low friction and super smooth tube ensures non-traumatic intubation.
- Distal end of the tube is coned with two lateral eyes
- Proximal end is provided with female luer mount for easy connection to feeding funnel or syringe.
- Radio - opaque line is provided for accurate tube placement.
- Colour coded for easy and instant size identification.
- Sterile and disposable, for single patient use.
- Individually packed in paper pouch.

Size	FG 5	FG 6	FG 7	FG 8	FG 9	FG 10
Colour	Grey	Green	White	Light Blue / Sky Blue	Orange	Black

Length – 50 cm. Pack of 25/Master Box of 5000

Gastrofede



- Naso-Gastric feeding device with 1.2 Litre size feeding bag
- A giving set is provided and at the end of which has a nozzle to fit all sizes of Feeding Tubes.
- With GASTROFEDE, enteric feeding is hygienic, more convenient, non – messy and can be given at any desired rate.
- Sterile and disposable, for single patient use.

Pack of 25/Master Box of 100

Instavac



- Close wound drainage device under negative pressure.
- Provided with the option to use one or two catheters post - operatively.
- Kink resistant connecting tube and is provided with additional strength to withstand the suction.
- Graduated Bellow is more transparent for easier monitoring of volume.
- Multiperforated catheters provided with radio opaque line and satin smooth perforation.
- Sterile, pyrogen free and disposable.
- Individually packed in a box.

Unit consists of: -

- Bellow unit capacity 800 ml.
- Connecting tube with clamp and "Y" connector.
- Curved needle with catheter.
- Spare perforated Redon drain catheter.

Size	FG 10	FG 12	FG 14	FG 16	FG 18
Colour	Black	White	Green	Orange	Red

Pack of 1/Master Box of 50

## Umbilical Cord Clamp

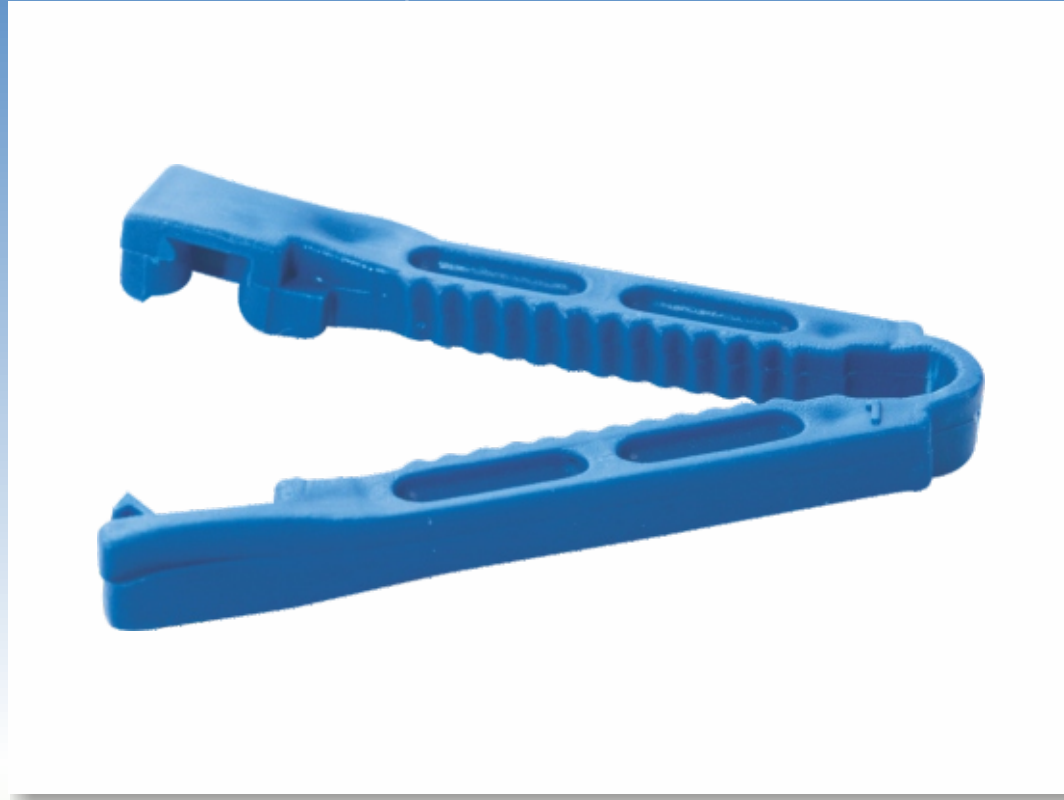

- Designed for clamping the umbilical cord of new born baby immediately after the birth.
- Provided with double purpose security lock click to indicate the correct locking and protect against accidental reopening.
- Finger grip ensures safe and convenient handling, particularly when gloves are wet.
- Grooved clamping area to prevent slipping of the umbilical cord and to retain it in the same position.
- Manufactured from non toxic medical grade polymer.
- Sterile, pyrogen free and disposable.
- Individually packed in Blister pack.
- Available in blue, other colours are available on demand.

Pack of 100/Master Box of 5000

## Mucocom

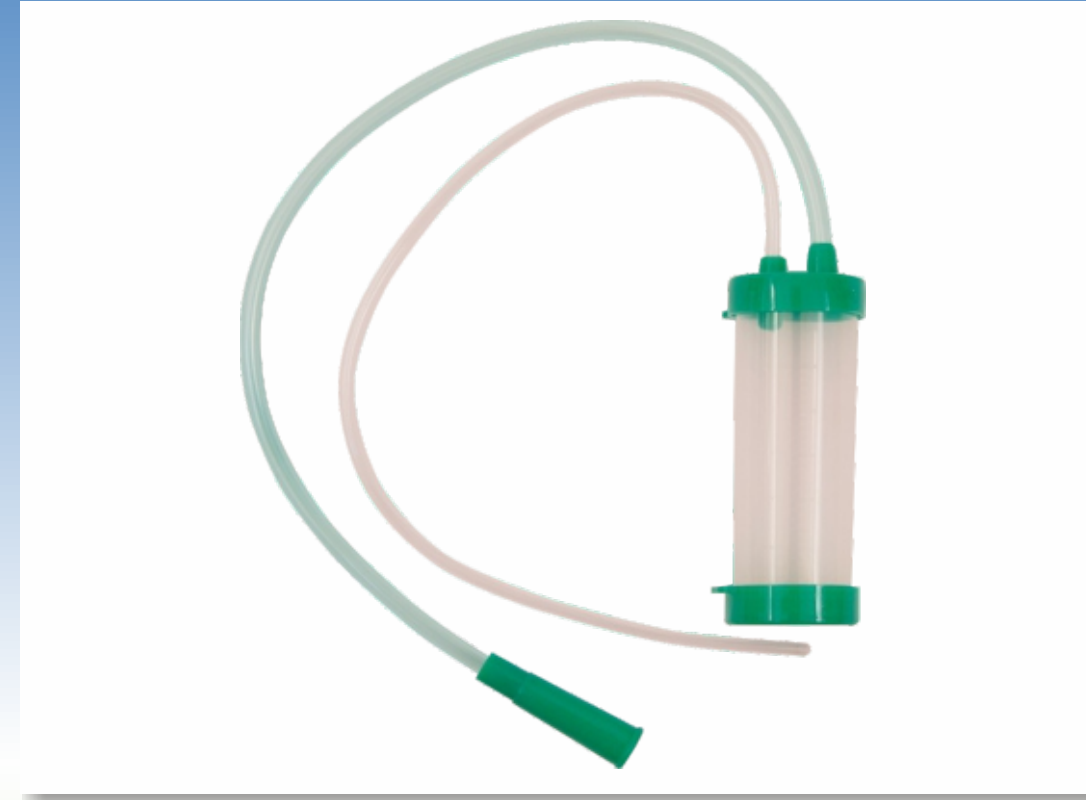

- Specially designed for aspiration of secretion from Oropharynx in newly born babies to ensure free aspiration.
- Helps for microbiological examination of the extracted mucus specimen
- Transparent container helps immediately for visual examination of the aspirate collected.
- Spare top cap is provided to seal the container for safe transportation of specimen to laboratory or for aseptic disposal of container.
- Low friction surface of catheter is provided with open end silk smooth round tip, for trauma free insertion and suction.
- Soft, frosted & kink resistant PVC tubing
- Sterile, pyrogen free and disposable.
- Individually packed in paper pouch.

Capacity – 25 ml. Pack of 25/Master Box of 1000





Ready to use Enema 100 ml.  
Given easily, quickly and hygienically.  
Relief in just 1-5 minutes.

You may be constipated if you have three or fewer bowel movements in a week, and your stools are hard, dry, and difficult to pass. In this situation, Practo – Clyss can help fast. Practo – Clyss provides gentle relief without pain or spasm.

It works by drawing water into the colon to soften the stool to help produce a bowel movement.

**Practo – Clyss is also ideal for: -**

- Bowel cleansing before undergoing a rectal examination.
- Constipation
- Rectoscopy and radiography of small pelvis
- Pre or post – operative
- Obstetric procedures



#### FOR MALE ERECTILE DYSFUNCTION

An F.D.A. (USA) approved medicine for impotence – Yohimbine is an alkaloid isolated from the bark of yohimbine tree (*Pausinystalia Yohimbine*) native to West Africa. Yohimbine is a 3a-15a-20B-17a-hydroxy Yohimbine-16a-carboxylic acid methyl ester. Yohimbine is an indolalkylamine alkaloid with chemical similarity to reserpine. It is a crystalline odourless powder.

Yohimbine increases libido but its primary action is to increase the blood flow to erectile tissue. It is a selective alpha-2 receptor antagonist. YOHIMBINE IS EFFECTIVE IN BOTH PSYCHOGENIC AND ORGANIC CAUSES OF IMPOTENSE. The maximum effect of Yohimbine takes two to three weeks to manifest itself. The standard dose of Yohimbine Hydrochloride is 12 to 20 mg per day. Higher doses have been reported to be more effective, though with side effects.

**ACTION:** Yohimbine blocks presynaptic alpha-2 adrenergic receptors. Its action on peripheral blood vessels resembles that of reserpine though weaker and of shorter duration. Its effect on peripheral autonomic nervous system is to increase parasympathetic (cholinergic) and decrease the sympathetic (adrenergic) activity. It is noted that in male sexual performance, erection is linked to cholinergic activity and to alpha-2 adrenergic blockade which may result in increased penile inflow and decreased penile outflow of blood. Yohimbine exerts a stimulating action on the mood in higher doses. It has a mild anti-diuretic action. It exerts no significant influence on cardiac stimulation and other effects mediated by B-adrenergic receptors.

**INDICATIONS:** Considered as the safest and effective medicine for male sexual disorders, YOHIMBINE HYDROCHLORIDE TABLETS are indicated in male erectile dysfunction of organic or psychogenic origin, lack of or low libido and for stimulation of male sex drive.

**SIDE EFFECTS:** In high doses, Yohimbine may cause Dizziness, nausea, headache, skin flushing and alteration in blood pressure and heart rate. Dosage should be reduced in accordance with individual patient's tolerance and raised gradually.

**CONTRAINDICATIONS:** Renal Disease, psychological imbalance, gastric and duodenal ulcers and sensitivity to Yohimbine – such as antidiuresis, mood modifications, and hallucinations. It is not recommended in geriatrics or in conjunction with mood modifying drugs.

**DOSAGE:** Initiating with 1 tablet t.i.d. gradually increase to 2 or 3 tablets t.i.d. over three weeks...therapeutic treatment not to exceed ten weeks.



Rubifol is a well - balanced standardised combination of Vitamin B12 and Folic acid presented in the form of uncoated chewable tablets for sublingual administration.

Folic Acid potentiates the action of Vitamin B12 in the rapid regeneration of haemoglobin. Both these factors act in combination and are essential for effective management of: -

- Mouth Ulcers
- Tongue Ulcers
- Stomatitis and Glossitis
- Sprue
- Megaloblastic Anaemias
- Optimum function of bone marrow
- Nutritional Supplement In Early Pregnancy and Old Age

Folic Acid when combined with Vitamin B12 is more efficacious in macrocytic anaemias, as in these cases a dual deficiency of both Folic Acid and Vitamin B12 exists.

Vitamin B12 is a key to the transformation of folate to Methylene Tetrahydrofolate, a substance involved in DNA production and therefore promotes proper development of red blood cells.

Indigestion and intestinal disorders that often complicate megaloblastic anaemias and the diarrhoea of tropical sprue are also promptly corrected by the use of RUBIFOL.

Foetal Neural Tube Defects (NTDs) may begin to develop within 18 to 30 days after conception – before a woman may know that she is pregnant. Hence, a woman's Vitamin B12 and Folic Acid reserves need to be good at the time of conception.

Infants are significantly protected from congenital Neural Tube Defects if their mothers take RUBIFOL as a dietary supplement during early pregnancy. This improves the folate status of child-bearing women and has the potential to prevent the misery of NTDs in the new – born infants.

Ten to twenty percent of the elderly are diagnosed as having low levels of Vitamin B12.

**DOSAGE:** For mouth and tongue ulcers, 2 tablets of RUBIFOL thrice a day sublingually ensures a speedy recovery. Higher doses can be given safely according to the severity of ulceration.

For sprue, Macrocytic anaemias of pregnancy and as dietary supplement in early pregnancy and in old age patients, an oral therapy of 2 to 4 tablets per day will suffice.

**COMPOSITION:** Each uncoated tablet of RUBIFOL contains –

Vitamin B12 I.P.....15 mcg.  
Folic Acid I.P.....1.5 mg.



Colchicine today remains to be the rationale therapy for all attacks of gout, namely: -

- Acute attacks of gout
- Subacute gout
- Chronic Rheumatic gout

Full advantage is taken of Synergism in the composition of Colchicine Tablets so that the following effects are obtained: -

- Anti-inflammatory
- Analgesic
- Uric Acid Elimination

These tablets get down to the root of the trouble in gouty and rheumatic conditions, and are so well tolerated that they are ideal for the sustained administration necessary in the treatment of these conditions.

#### DOSAGE AND METHOD OF USE:

Colchicine is available in granules each containing exactly one milligram (1/64 gr.) Packed in Bottles of 40 granules.

- Acute attacks: - In florid gouty patients with normal heart and active emunctories, one should give larger doses first as recommended by Laborde and Houde: 4 granules on the first day, at a quarter of an hour intervals; 3 granules the second day; 2 on the third day and 1 on the fourth day. A rapid alleviation of the pain is thereby obtained.

In moderate cases, or when patient's susceptibility is not known, on the first day, 3 granules divided in three doses at intervals of one or two hours; 2 granules in two doses on the following days should be administered. The treatment should be continued for four days but should not exceed more than seven days. We recommend these moderate doses for the majority of cases.

For debilitated gouty patients begin with small doses: 1 or 2 granules a day, increasing to 3 daily but not exceeding more than 3.

Regardless of the dose administered, discontinue the treatment as soon as the pain has been relieved. The medication should also be suspended if there is diarrhoea or vomiting. The attack should be treated as early as the second day (Loeper) or even on the first day (Critzman).

- Subacute and chronic attacks in the rheumatic gout: or 2 granules daily are indicated.
- As a preventive of acute attacks, when there is pain and slight swelling of the toe, give 1 granule (2 for florid patients) at night on retiring, with half a glass of water. Repeat the dose next day if necessary.





Papaverine is recommended in various conditions accompanied by spasm of smooth muscle, such as vascular spasm associated with acute myocardial infarction (coronary occlusion), angina pectoris, peripheral and pulmonary embolism, peripheral vascular disease in which there is a vasospastic element, or certain cerebral angiospastic states; and visceral spasm, as in ureteral, biliary, or gastrointestinal colic.

The most characteristic effect of papaverine is relaxation of the tonus of all smooth muscle, especially when it has been spasmodically contracted. Papaverine hydrochloride apparently acts directly on the muscle itself. This relaxation is noted in the vascular system and bronchial musculature and in the gastrointestinal, biliary, and urinary tracts.

The main actions of papaverine are exerted on cardiac and smooth muscle. Papaverine relaxes various smooth muscle, especially those of larger arteries; this relaxation may be prominent if spasm exists. The antispasmodic effect is a direct one and unrelated to muscle innervation, and the muscle still responds to drugs and other stimuli causing contraction. Papaverine has minimal actions on the central nervous system, although very large doses tend to produce some sedation and sleepiness in some patients. In certain circumstances, mild respiratory stimulation can be observed, but this is therapeutically inconsequential. Papaverine stimulates respiration by acting on carotid and aortic body chemoreceptors.

Papaverine relaxes the smooth musculature of the larger blood vessels, including the coronary, cerebral, peripheral, and pulmonary arteries. This action is particularly evident when such vessels are in spasm, induced reflexly or by drugs, and it provides the basis for the clinical use of papaverine in peripheral or pulmonary arterial embolism.

Experimentally in dogs, the alkaloid has been shown to cause fairly marked and long-lasting coronary vasodilation and an increase in coronary blood flow. However, it also appears to have a direct inotropic effect and when increased mechanical activity coincides with decreased systemic pressure, increases in coronary blood flow may not be sufficient to prevent brief periods of hypoxic myocardial depression.

Papaverine is effective by all routes of administration. A considerable fraction of the drug localizes in fat depots and in the liver, with the remainder being distributed throughout the body. It is metabolized in the liver. About 90% of the drug is bound to plasma protein. Although estimates of its biologic half-life vary widely, reasonably constant plasma levels can be maintained with oral administration at 6-hour intervals. The drug is excreted in the urine in an inactive form.

#### DOSAGE AND ADMINISTRATION:

Papaverine hydrochloride may be administered intravenously or intramuscularly. The intravenous route is recommended when an immediate effect is desired, but the drug must be injected slowly over the course of 1 or 2 minutes to avoid uncomfortable or alarming side effects.

Parenteral administration of papaverine hydrochloride in doses of 1 to 4 ml is repeated every 3 hours as indicated. In the treatment of cardiac extrasystoles, 2 doses may be given 10 minutes apart.

## Welcome to the new Atul Drug House

**adh ATUL DRUG HOUSE**

**Range of Herbal Treatments**

**adh ATUL DRUG HOUSE**

**Healthcare, Hygiene and Disinfection**

Antiseptics & Disinfectants, Hand disinfection, Iodine Antimicrobial Solutions, Creams and Gels, Floor and Surface Disinfection, Sterilants and High Level Disinfectants, Oral Treatment and Antimicrobial Wipes

**Medical Applications**

- Surgical Scrubs
- Hand Disinfectants and Sanitizers
- Topical Antiseptic Solution and Creams
- Pre-Operative Solutions
- Equipment Sterilization Solutions
- Antimicrobial Wipes
- Antimicrobial Solutions and Creams
- Oral Care Solutions and Gels
- Obstetrics Creams

**Personal Care**

- Antimicrobial hand Disinfectants (Alcohol and Non-Alcohol Based)
- Sanitizing Gels and Foams
- Antimicrobial Wipes
- Foot Care and Antimicrobial Disinfectants

**adh ATUL DRUG HOUSE**

**adh ATUL DRUG HOUSE**

**Advanced Protection through Innovation**  
**DISPOSABLE DRAPES AND PACKS**

**adh ATUL DRUG HOUSE**

**BIOMEDICAL, PHARMACEUTICAL WASTE SHREDDING MACHINES & NEEDLE SYRINGE DESTROYER**



85, Dr. Annie Besant Road, Worli, Mumbai 400018. INDIA  
Tel.: +91-22-24931492 / 93 Fax: +91-22-2495 2687  
Email: [atuldrughouse@vsnl.net](mailto:atuldrughouse@vsnl.net) [visha321@gmail.com](mailto:visha321@gmail.com)  
Website: [www.atuldrughouse.com](http://www.atuldrughouse.com)



+91 9819164991 +91 9820024000